



Gilmore Lighting Design Celebrates 20th Anniversary

New Year Greetings!

Gilmore enters 2018 with happy reflection, marking 20 years in business as independent architectural lighting designers. Formed in 1997 by principal Debra Gilmore, the firm as a certified woman-owned business has provided lighting solutions for international and domestic projects, including iconic sites in Baltimore, MD, Washington, DC, and a UNESCO World Heritage Site in the Kingdom of Saudi Arabia.

Thank you to all those who gave us design and business opportunities, including clients, consultants, vendors, the press, current and former employees, friends and family. Wishing all of you a fruitful and luminous 2018.

Sincerely,
Debra Gilmore, IALD, MIES



Photo by Jessica Marcotte

Gilmore's current projects include

DC Fish Market and Entertainment Cruises at the District Wharf along the SW Waterfront in Washington, DC

The National Aquarium Waterfront Campus in Baltimore, MD, a redevelopment of public space to include a floating wetland, interactive piers and terraces

Redevelopment of the historic Monticello Dairy building and site in Charlottesville, VA

NoMa Green Park, a 2.5-acre parcel in the historic Eckington neighborhood in Washington, DC

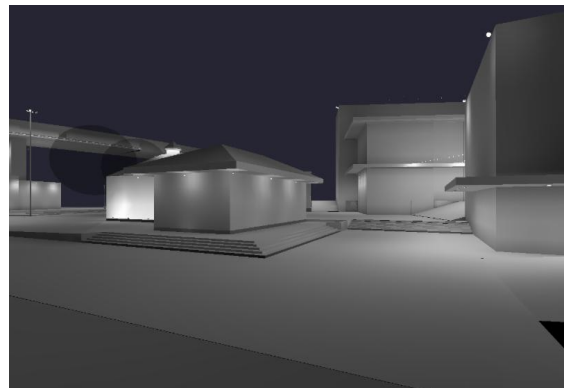

DC Fish Market, Washington, DC - Study model

Gilmore provided lighting design for these following projects

- [Asia Trail](#) and Conservation Plaza, Smithsonian National Zoological Park, Washington, DC
- [Exelon](#) Baltimore Headquarters, Baltimore, MD
- NIH Porter Neuroscience Research Center, Bethesda, MD
- Bureau of Engraving & Printing Visitor Center, Fort Worth, TX
- Capital Yacht Club at the District Wharf, Washington, DC
- Eagle Academy Public Charter School, Washington, DC



Exelon Baltimore Headquarters, Baltimore, MD



Asia Trail, Washington, DC

Gilmore designed lighting for these international projects

In Sweden, Ms. Gilmore was selected as a workshop head for [Lights in Alingsas](#) 2016, a public annual exterior lighting event that takes place along a 2.5-kilometer trail in Alingsas, Sweden.



Christinae Church, Alingsas, Sweden

In Qatar, Gilmore designed the lighting for The American School in Doha, and Graduate Housing Exterior Studies for Education City.

In Saudia Arabia, Gilmore's projects include: [Atturaif Living Museum](#), a 58-acre UNESCO World Heritage Site in Old Diriyah, near Riyadh.

The project is currently in construction and expected to open in spring 2019. The second, Al Doho, comprises 15 city blocks within a historic area of Riyadh.



Atturaif Living Museum Visitor Reception Center,
Old Diriyah, Saudi Arabia

President Debra Gilmore, who serves as principal designer and directs all lighting projects at Gilmore Lighting Design, has more than 35 years experience working with real estate developers, architects, exhibit designers, landscape architects and engineers; she has provided lighting services to universities, corporations, institutions, museums, botanical gardens and public parks. She is a member of the International Association of Lighting Designers (IALD) and Illuminating Engineering Society (IES). Gilmore's projects have received numerous professional lighting awards, as well as receiving AIA recognition.

Gilmore moves into this new year celebrating successful years past, and taking inspiration from the wisdom of these words:

"One does not become enlightened by imagining figures of light,
but by making the darkness conscious."
Carl Jung

The newsletter header graphic abstracts the top view of sculpture titled, 'Flashpoint'. Designed by public artists David and Eli Hess and commissioned by Pepco, the monumental-sized piece will be in front of the new Buzzard Point Pepco Substation across from DC United's new stadium under construction in SW Washington, DC. Gilmore was hired by the artists to collaborate on lighting the sculpture.

VISIT OUR WEBSITE



Gilmore Lighting Design, 7939 Norfolk Ave., Bethesda, MD 20814

[SafeUnsubscribe™ {recipient's email}](#)

[Forward this email](#) | [Update Profile](#) | [About our service provider](#)

Sent by gilmore@gilmorelight.com in collaboration with



Try it free today