

LIGHT READING

March 2014

Dear Colleagues, Friends, and Clients,

SpRinG!

Say hello to a most highly-celebrated season, even in climates without a winter of cold temperatures. Specifically, March 20 marks the Vernal Equinox, the special time of year when the amount of daylight and darkness are equal. Folklore says this is the day when you can balance an egg on its end due to an equalization of gravitational pull. Others say, this feat can be accomplished any time of year.

While much of the Northeastern United States will soon celebrate warmer weather and blooming flowers, other latitudes with temperate winters and perhaps year round green, simply revel in more hours of natural light as the days grow longer.

More hours of natural light facilitates outdoor recreation after the normal work day. However in dense, urban areas where tall buildings shadow parks or when people work late, planning for better 'pedestrian level' lighting in parks as opposed to relying on street or floodlights, has garnered attention from facility planners, landscape architects, light fixture manufacturers, and lighting designers.

Debra Gilmore, IALD, MIES
Gilmore Lighting Design

MNCPPC

Since 2009, Gilmore Lighting Design has been working with the Maryland National Park & Planning Commission on different properties to enable park users extended hours to recreate. Like many other municipal planning agencies, MNCPPC understands more recreational space will be needed for it's expanding population and planned growth. Recent studies indicate that Americans have the highest rate of obesity among developed countries and some experts say that over one third of the country's population is now too heavy. Diet and exercise are the only way out from a work day consisting of sitting. Park and recreation spaces that remain inviting after the workday ends, provide a path back to healthy living.



Germantown Center Urban Park, covers 8 acres of sloping hills in Montgomery County near the Germantown Regional Library. Scheduled to be completed later this year, it will include boardwalks, interpretive trails, terraces and a pavilion all to provide an active green space for

sedentary workers and their families seeking a place to stretch their legs. Gilmore Lighting Design provided the plan that will define the usable night spaces and boost the parks' nocturnal popularity.

Brookside Gardens, a popular destination and an award-winning public display garden located in Wheaton, Maryland has started construction on a much awaited project. The 2005 Master Plan recognized the need to create an aesthetic, informative, and safe arrival experience for all visitors. Gilmore



Lighting Design has been involved in the Phase I & II implementation that includes improving the entrance and parking area. The grounds include 50 acres of foliage and fauna divided into 8 separate gardens including aquatics, azaleas, and roses along with a Children's garden, a butterfly garden, a Japanese garden and more. In later phases, a comprehensive assessment will be made as to how much of the property should be illuminated.

And finally in regional park news, Gilmore Lighting Design was notified that the Woodside Urban Park Facility Plan report has won a 2014 ASLA Potomac Chapter Honor Award for Master Planning. Gilmore's schematic lighting design helped win the award, but more importantly contributed to the comprehensive park design budget approval by the MNCPPC Board of Directors. Construction is scheduled for 2018.

In conclusion, the Vernal Equinox renews our spirits with the promise of more daylight. Is it the longer days that encourages the joy, the

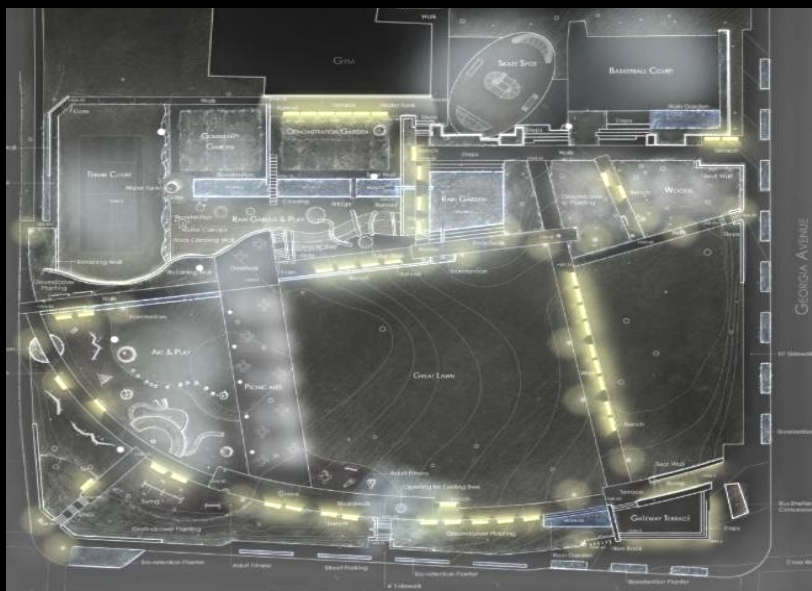

anticipation of the outdoor activities or the final departure of winter? As we become aware of a new growing season, we might reflect back to recent history and decide that it's not too early to plan for the next season of darkness. To maximize each day until then, consider the following tools

for tracking sunrise and sunset times, including one that sends SMS alerts.

<http://www.timeanddate.com/worldclock/astronomy.html?n=263>

<https://ifttt.com/recipes/155408-see-more-sunsets>



Gilmore Lighting Design | | gilmore@gilmorelight.com |
7939 Norfolk Ave.
Bethesda, MD 20814